

# SPECIAL KNURLING WHEELS

## No. 60 – BEAD KNURLING WHEELS

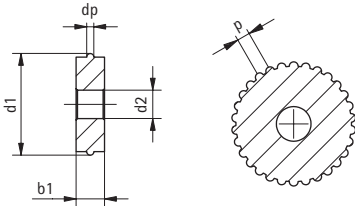
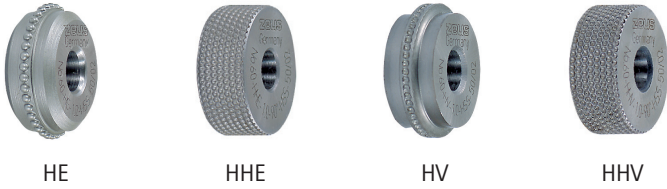

**Note:** Please specify the bead diameter.

## No. 70 – CONICAL KNURLING WHEELS

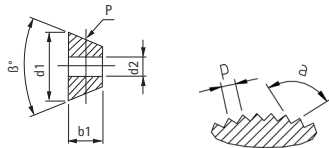
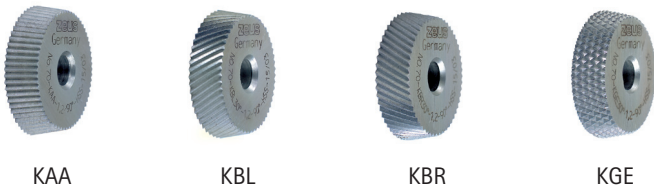

**Note:** The completeness of the teeth numbers on the knurling wheel depends on the width/pitch of the knurl.

## No. 80 – CONVEX / CONCAVE KNURLING WHEELS

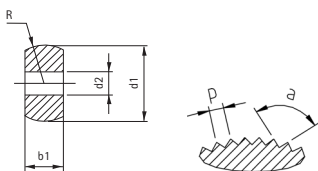
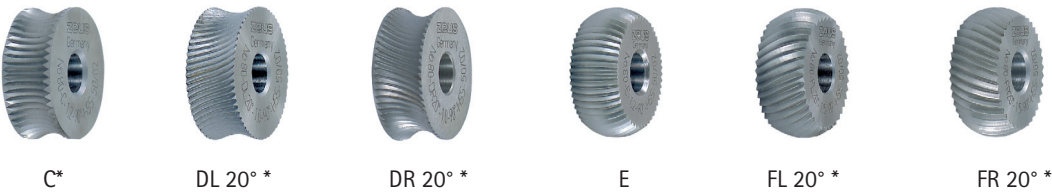

Model DL, DR, FL, FR: maximum 20° spiral angle

\* With radius < 3 = formed version

With radius > 3 = milled version

## No. 90, 92, 93 – SPECIAL KNURLING WHEELS

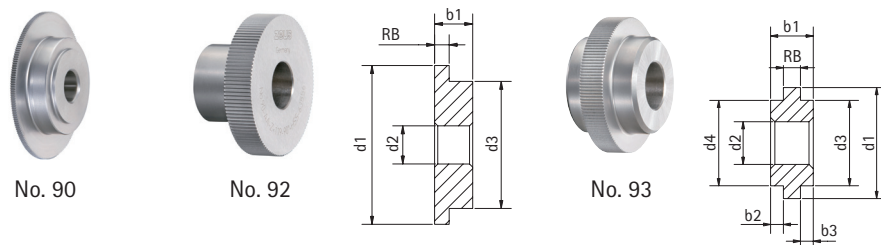

The picture of knurling wheel No. 90 is only an example. No. 90 stands for all special designs, which are not covered by No. 92 and No. 93.