

FUNCTIONS

- Functions:
- ON/OFF
- Auto OFF after 2 hours

FEATURES

Excellent readability thanks to combined display:

- bar graph for dynamic path information
- digital display for exact readings

- Can be controlled independently of a machine tool
- Large working range in all axes (X, Y, Z) prevents damage to the stylus by contacting errors
- Compact metal housing and long probe arm
- Shockproof movement
- **IP protection category: IP 65**
- **Package contains:** battery, instruction manual, stylus 802 EWt

Application:

- Can be used on milling and CNC machines to
- determine the zero position on workpieces
 - determine the center of bores
 - determine and correct the alignment of a workpiece and for the measurement of
 - lengths
 - depths



TECHNICAL DATA

| | | |
|-----------------------------------------------------|------------------|------------|
| Order no. | 4304300 | |
| Product type | 802 EW | |
| Resolution | mm | 0.005 |
| Working areas, X-, Y-, Z-axis | -2 to 4 mm | |
| Repeatability at zero point, uni-directional | inch | ± 0.005 mm |
| Standard | Factory standard | |

| Order no. | Mounting shaft |
|-----------|----------------|
| | mm |
| 4304300 | 16 |

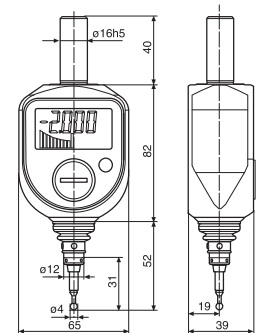

ACCESSORIES

| Order no. | Product name | Product type |
|-----------|----------------------------------------|--------------|
| 4304320 | Stylus \varnothing 4.0 mm, l = 31 mm | 802 EWt |
| 4102520 | Battery 3 V, CR 2032 | |

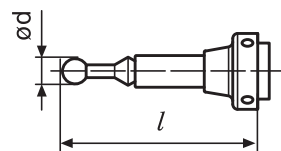

802 EWt; 802 NWt